

4.000 (101.6mm)

Dynafit Superlight 2.0 (from Wildsnow.com & Powerguide.com)

Printing Instructions (for CorelCAD)

1. Print from Model space.
2. Use profile: HP_Laserjet_Letter_Scaled
3. Specify laser printer
4. Specify print range & select corners of 8.0225 x 10.382 box

4.000
(101.6mm)

Box at left should measure 4" x 4" (101.6 x 101.6mm) when printed at 100%.

Toe mount is identical to Radical-1 (30 x 39mm) and template was cross-checked against powderguide.com, wildsnow.com & skimo.com.

Radical-1 15mm toe pin offset taken from powderguide.com

Heel holes cross-checked against wildsnow.com & skimo.com

- Toe hole spacing: 30(w) x 39(l)
- Heel hole spacing: 34(w) and 28(w) x 28(l)

10-May-2017: Template tested with mount of auvgeek's skis.

Test mount **STRONGLY RECOMMENDED** to produce correct 5.5mm tech gap at heel (due to both boot sample variance and individuals' differing techniques in scribing heel mark).

Note: If you use the front of toe "window", a slight fore/aft shift may occur because not all "pin-serts" are 15mm from front of boot.

Sequence:

1. Locate/mount toe (and insert boot)
2. Scribe the heel line using the TOP of the HEEL LEDGE with a CARPENTER'S SQUARE to locate heel mount point. The top ledge overhangs the bottom of the boot by about 2.3mm.

Toe Piece

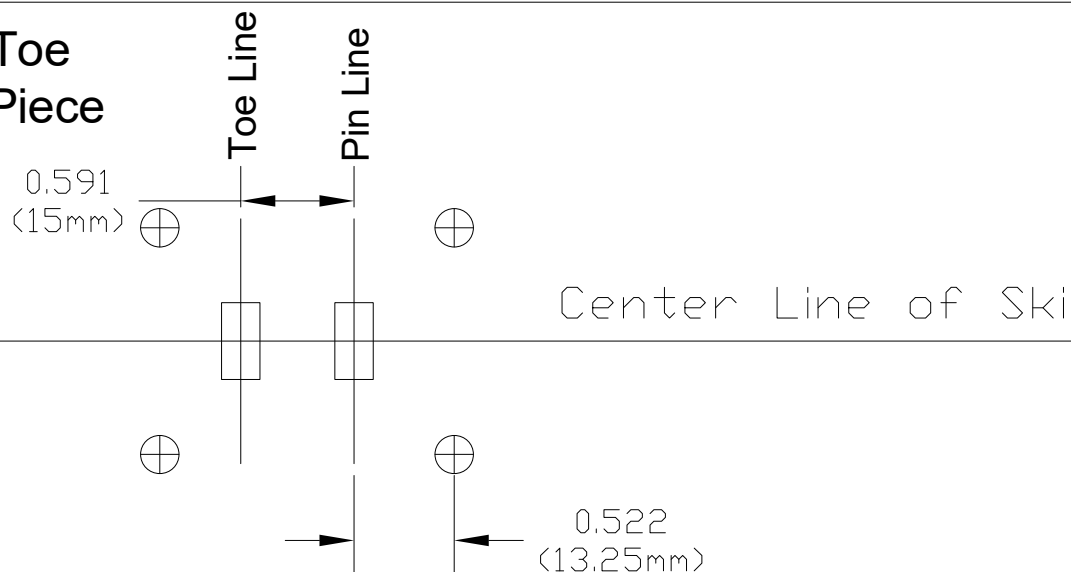

Heel Piece

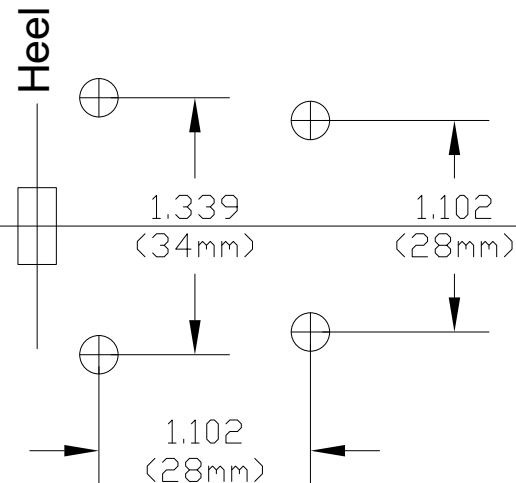

<-- Front of Ski

Tail of Ski -->